

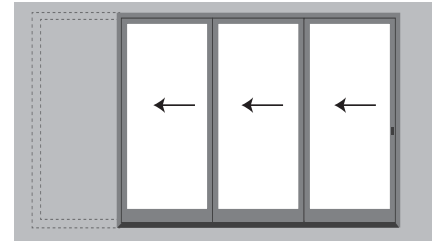

# EC Multi-Slide Pocket Door Installation Guide



## Installation Recommendations for Fin Frame Doors

These installation recommendations are made available by MI Windows and Doors, LLC (MI) to assist with the integration of mounting fin sliding glass doors into a typical wood-framed structure less than three stories in height. Installation into other structures and frame types are not addressed here. Please contact MI or visit [www.miwindows.com](http://www.miwindows.com) for additional information.

## Important Design Considerations

Read this entire document before proceeding with installation of MI's products. Responsibility for product selection and installation rests with the owner, architect, and installer. Do not proceed with installation unless all factors necessary to properly integrate MI's products into a building's water management system have been addressed.

MI makes no representation or warranty that these recommendations include all information necessary to ensure proper integration into every building. State and local code requirements may impose different or additional demands, which will supersede these recommendations. For additional guidance regarding installation of door products refer to applicable industry standards (e.g., AAMA 2400, AAMA InstallationMasters™, ASTM E 2112).

Failure to follow these recommendations, local requirements, or good building practices may affect the availability of remedies under MI's warranty. Provide a copy of these recommendations and the applicable MI warranty to the owner before installing. MI does not permit adoption of its installation recommendations into the contracts of others without its prior, written consent.

### Manufacturer's Note:

It is highly recommended that Multi-Slide systems are installed in areas with sufficient overhangs as required to prevent water or air infiltration. Failure to do so may result in structural damage to the surrounding area, finishes and/or systems.

It is also recommended that Multi-Slide Patio Door systems are installed by a certified installer, using a sill-pan.

## Important Pre-Installation Considerations

- Door installation may disturb finish surfaces and paint in existing structures. Specific notice and work site precautions may be required. Additional information is available at [www.epa.gov/lead](http://www.epa.gov/lead). Comply with all applicable federal, state, and local requirements.
- Job site and worker protections are recommended and may be required. Follow all manufacturers' instructions for appropriate and safe use of protective equipment, tools, materials, hardware and site protections necessary for installation.
- Special disposal considerations may be necessary for materials used during installation. Materials removed from an existing structure may also have their own disposal or recycling requirements. Comply with all applicable federal, state, and local requirements.
- Product specification sheets include important information regarding your product and may include additional installation recommendations, such as fastener use with impact resistant doors, finishing instructions, and appropriate use of low expansive foam insulation.

Contact MI for product specifications and additional product information for your MI product.

## Materials Required

- Non-compressible shims.
- Flexible membrane sill pan flashing system.
- Fasteners. Type and number as required by code. At a minimum, fastener type should be sufficient to properly affix the frame and penetrate rough opening by 1" or more.
- High quality compatible exterior grade sealant.
- Seal tape for the weather resistive barrier\*.
- Self-adhering flashing, in a width required by code but no less than 4". AAMA 711 compliant flexible butyl tape flashing or equivalent is recommended.\*
- Backer rod.\*
- Low-expansive, low-pressure foam or batt type insulation.\*

## Tools Required

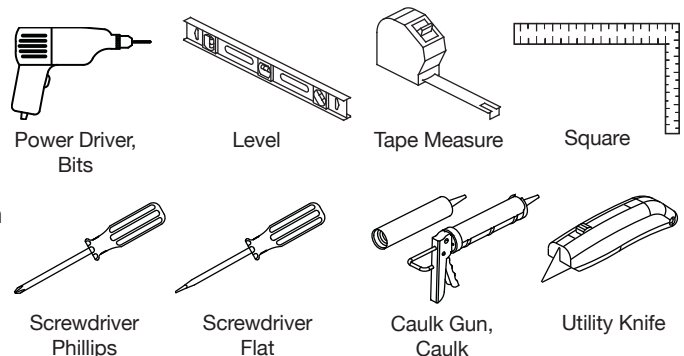

\* Use and placement of these materials may be required by code, plan, or good building practices.



**EC Multi-Slide Patio Door Panels**  
**Standard parts**

Complete Door panels  
1A - 1F

- Complete door panels 2, 3, or 4 panels with:
  - A. Rollers
  - B. Mortise
  - C. Interlock
  - D. Dust plugs
  - E. Sealing bridge
  - F. Bottom fin end cap

- Signature handle set (qty 1)  
Recessed interior & exterior  
Brushed Nickle

- Door Key



- Button plugs (2 per panel)
  - White WS30025C
  - Adobe WS30025J



- Collector plate (1 per I panel)  
White or Adobe



- Collector plate screws
  - #6 x 1" PFH (qty 5 per I panel)
  - White FS001550
  - Adobe FS00155D



- Gaskets (qty 2)

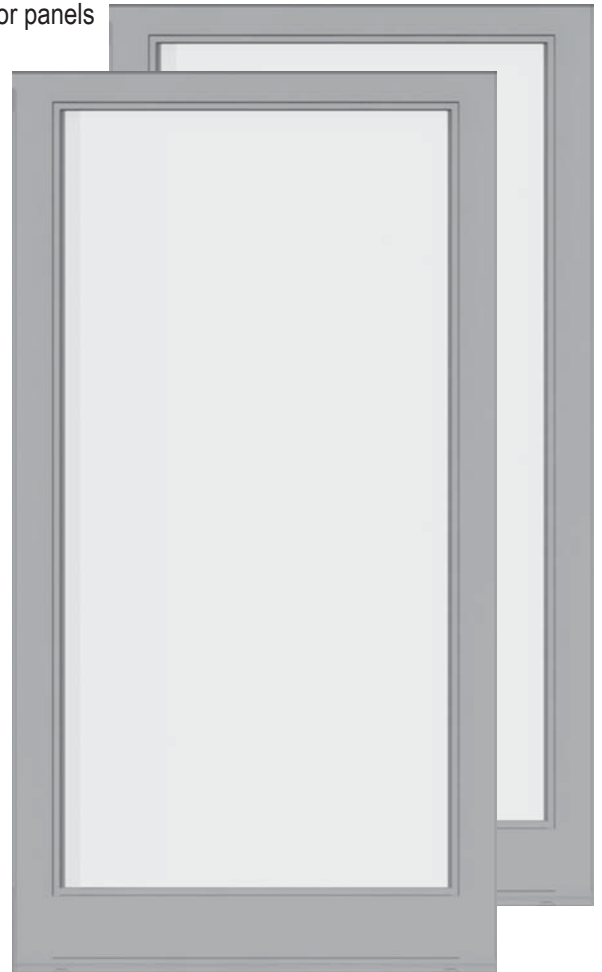

**Optional**

1" Fin  
(Included when ordered)



**EC Multi-Slide Patio Door Frame Kit**  
**Standard parts**

- Frame Kit (1)  
head, sill, side jambs, and  
pocket jamb interlock

- Panel stop (1 per operating panel)  
White, Adobe, or Bronze

- Frame screws (1 pkg)

- Installation screws (1 pkg)

- Two point lock keeper - installed (1)

- 1-3/8" Aluminum mounting fin

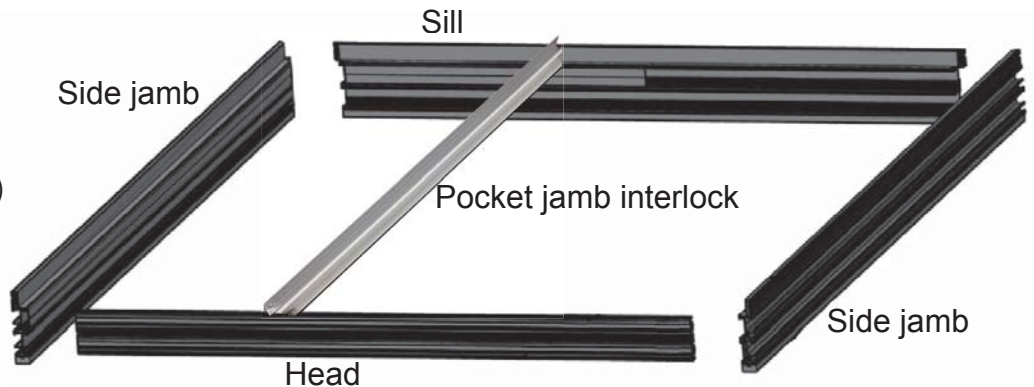

Frame & installation  
screws

## **Opening Preparation**

Inspect the rough opening prior to installation.

Confirm that the roof over the system is stacked and take into consideration the amount of weight of any materials at this location that may cause deflection of the header. No more than 1/8" deflection is allowable for proper system operation.

Verify that the concrete or sub-floor where the system is to be installed is level. The frame system may be shimmed to compensate for an uneven floor but will adjust the relationship of the systems sill to the finished floor and may increase the overall height of the system in the opening. Any serious deflection in the concrete or sub-floor where the system is to be installed must be corrected prior to installation.

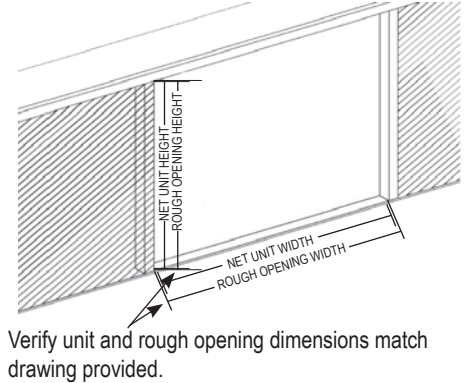
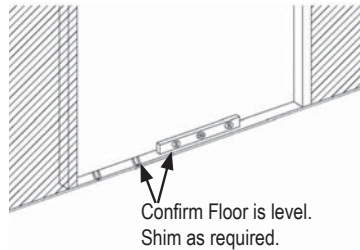
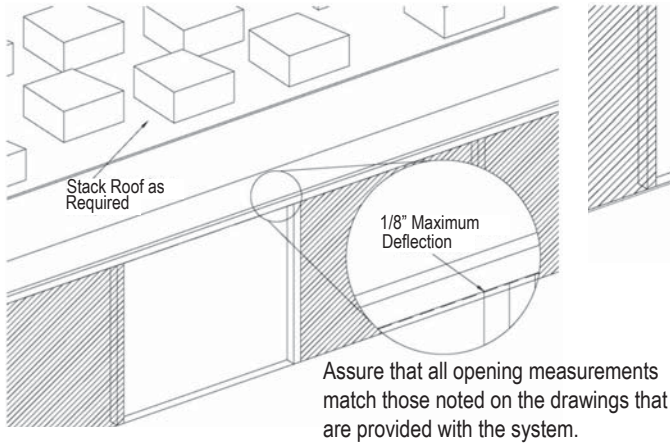

## **Frame Assembly**

Lay frame head, sill & side jambs on a flat surface with exterior side up.

Align the left side jamb to the outside top left edge of the head.

Attach the left side jamb to the head using screws supplied in the "Jamb Assembly" screw package.

Repeat to attach right side jamb to head.

Align left side jamb to the outside bottom edge of the sill.

Attach the left side jamb to sill using screws supplied in the screw package.

Repeat step to attach right side jamb.

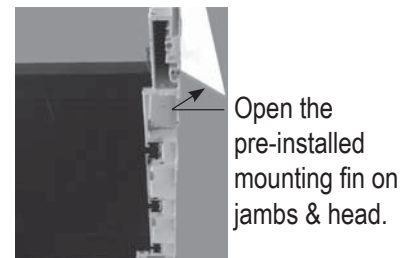
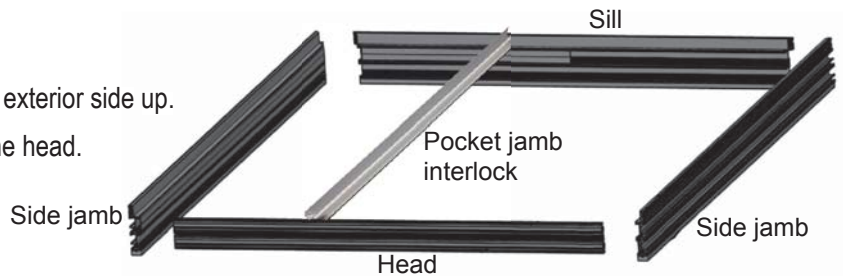

## **Pocket Jamb Interlock**

Attach pocket jamb interlock to the head & sill of assembled frame.

Align miter end of interlock to the miter end of the head.

Attach with screws that are provided.

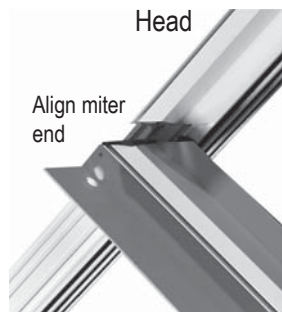

**Sill Plate Flashing and Sealant - RECOMMENDATIONS**

Installation of a moisture barrier on the concrete or sub-floor and flashing at the top and sides is recommended in accordance with building codes and/or acceptable practices in your area.

If the system is to be installed over a wood sub-floor, a sill pan or self sticking flashing is recommended at the sill.

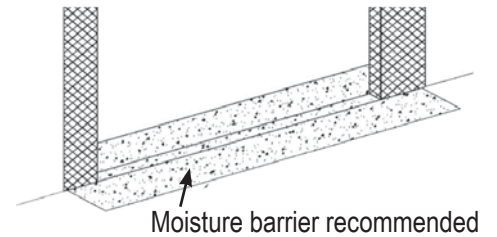

**Frame Installation**

Stand-up assembled frame and dry fit the frame in prepared opening. Using a straight edge and/or level to verify that the sill is level. Use shims as necessary to level and flatten the frame sill to the floor. Mark the sill on the inside with a pencil line on the floor to identify where the sill is located for final installation. For a cement floor pre-drill pilot holes with a hammer drill in the floor through the pre-drilled door sill.

Remove assembled frame and clean floor in preparation of final installation. For a cement floor finish drilling each hole to accommodate a Tapcon masonry fastener.

Apply a generous bead of sealant down the length of the floor on the inside and outside edge of where the frame sill will sit. Also apply generous beads of sealant perpendicular and in-line with the pre-drilled holes in the sill.

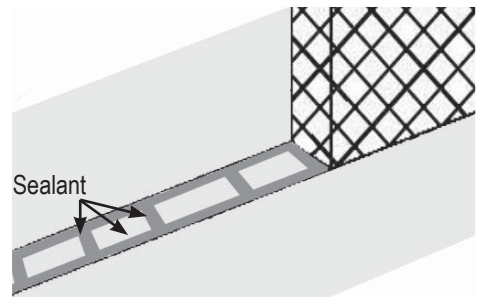

Before reinstalling the assembled frame apply additional sealant to the exterior joints of the frame, head to jamb and sill to jamb locations.

Stand-up assembled frame and set in prepared opening for final installation. Align sill to previous drawn pencil line on the floor. Using a straight edge and/or level to confirm sill is level. Position any of the previous shims to level and flatten the frame sill to the floor. Cross measure the frame to confirm there is no variance larger than 3/16" per measurement and that the frame is square to within 1/8" horizontally and vertically.

Prior to attaching the head to the prepared opening, square the frame to within the allowable tolerances. Using a straight edge and/or level, verify that the top track/head is level and flat. Use shims as needed to level and flatten the head.

Install 2-3 screws in the head through the pre-drilled holes using the screws located in the head install screw package.

The remaining screws will be installed after the panels are installed.

Using a straight edge and/or level, verify that the side jambs are level, plumb & straight. Use shims as needed.

Install 2 screws per jamb through the factory pre-drilled holes using the screws located in the screw package.

The remaining screws will be installed after the panels are installed

Attach sill to floor with screws provided through pre-drilled holes, per cross section drawing. **DO NOT** attach through the weep holes.

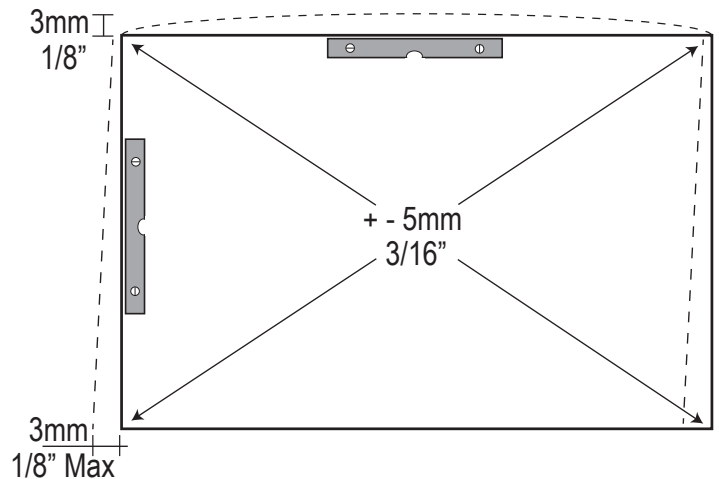

Sill Cross Section Drawing

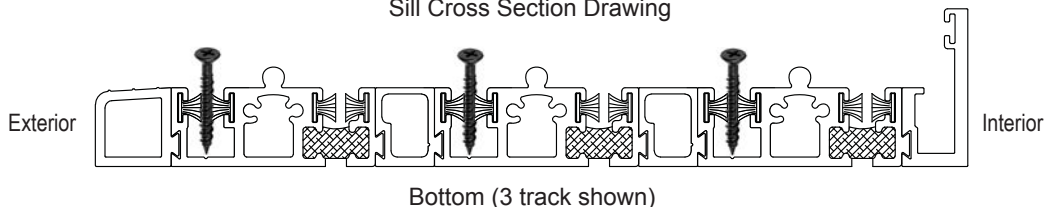

**Panel Installation**

Refer to the configuration drawings on page 4 to install door panels in the correct order. Beginning with the first panel to be installed, hold the panel at an angle toward the head track, insert the top of the panel into the inner most head track and swing the bottom of the panel inward until it is parallel with the top and sits with the wheels on the corresponding sill. Inside operator panel is installed first.

Repeat step for all remaining panels in sequential order.

Angle panel towards head track



**Handle Installation**

**Standard Handle Set**

Signature Series recessed interior and exterior handle. The standard handle set is boxed with a full set of instructions on how to install.



**Wheel Adjustments**

Once all panels are installed, close the system and make sure all panel stiles line up properly by adjusting wheels for proper alignment.

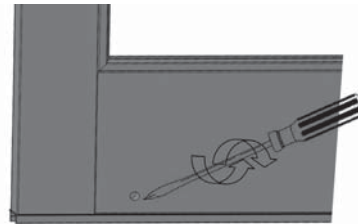

**Lock and Slide**

Perform a lock and slide before you continue with the next steps. Open, close, lock and repeat.

**Pocket Door Filler Bracket**

Attach the pocket door filler bracket to the "I" panel that is to the outside of the frame with provided lag bolts. Center the pocket door filler board on the bracket and attach with provided screws.

Filler board  
Filler bracket



**Collector Plate Installation**

**3 Panel Door**

Install collector plate on interior "I" panel jamb, 3/4" from top of panel with screws provided.



**4 Panel Door**

Install collector plate on interior "I" panel jamb, 3/4" from top of panel with screws provided. Center the second collector plate so the tab nests in the opening of the first plate installed.



3 Panel Door  
"I" panel jamb



4 Panel Door  
"I" panel jamba

**Install Button Plugs**



Install button plugs into the wheel adjustment holes when finished.

## 2 Track Pocket Doors

Configurations - Shown as viewed from outside.

### EC-192P

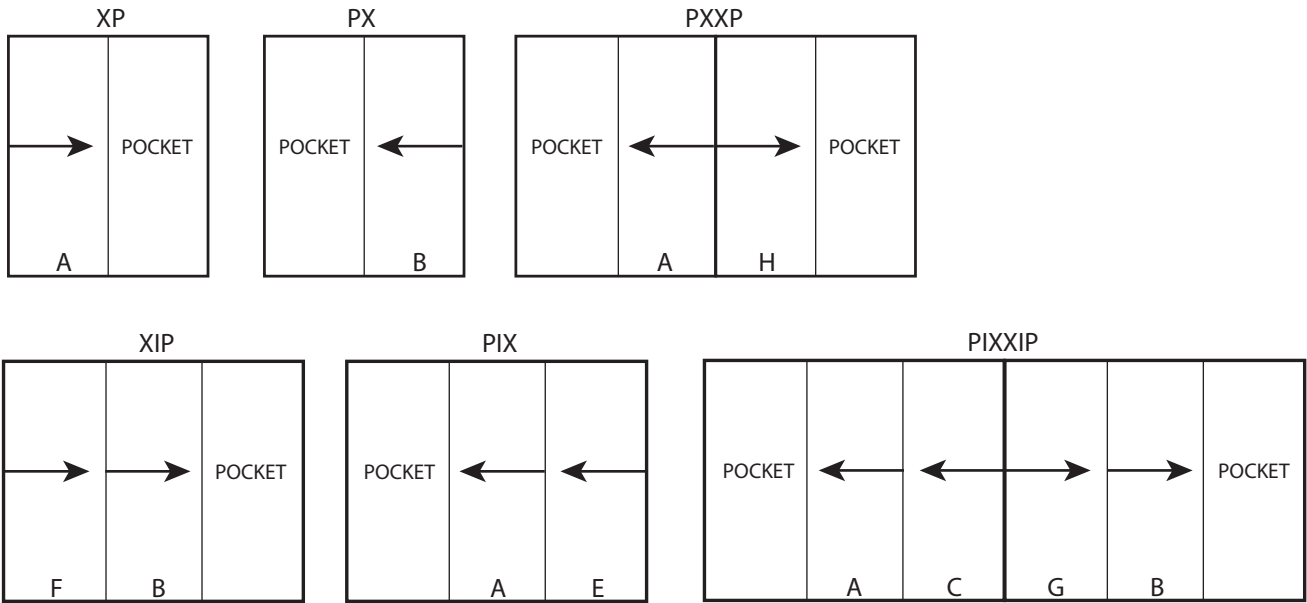

## 3 Track Pocket Doors

Configurations - Shown as viewed from outside.

### EC-193P

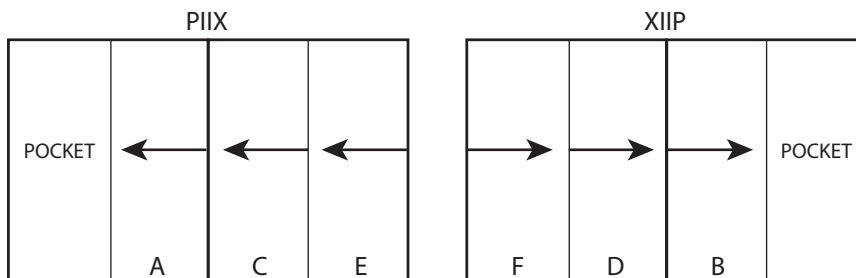

## 4 Track Pocket Doors

Configurations - Shown as viewed from outside.

### EC-194P

